

**Single Phase 0.8Amp Glass passivated Bridge Rectifiers**
**MBS**

**Features**

- The plastic package carries Underwriters Laboratory Flammability Classification 94V-0
- Idea for printed circuit board
- Glass passivated junction chip
- Low reverse leakage
- High forward surge current capability
- High temperature soldering guaranteed  
260°C/10 seconds at terminals

**Mechanical Data**
**Case :** Molded plastic body

**Terminals :** Solder plated, solderable per MIL-STD-750, Method 2026

**Polarity :** Polarity symbol marking on body

**Mounting Position :** Any

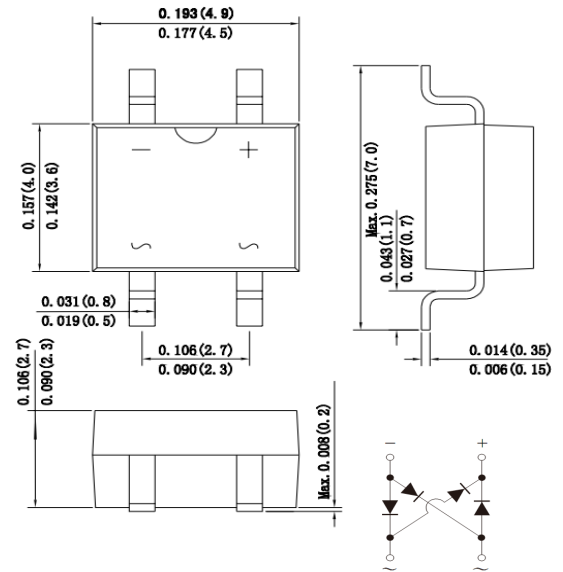
**Weight :** 0.004 ounce, 0.118 grams

Dimensions in inches and (millimeters)

**Maximum Ratings And Electrical Characteristics**

Ratings at 25°C ambient temperature unless otherwise specified. Single phase half-wave 60Hz, resistive or inductive load, for capacitive load current derate by 20%.

Parameter	SYMBOLS	MB05S	MB1S	MB2S	MB4S	MB6S	MB8S	MB10S	UNITS
Maximum repetitive peak reverse voltage	$V_{RRM}$	50	100	200	400	600	800	1000	V
Maximum RMS voltage	$V_{RMS}$	35	70	140	280	420	560	700	V
Maximum DC blocking voltage	$V_{DC}$	50	100	200	400	600	800	1000	V
Maximum average forward rectified current at $T_L=100^\circ\text{C}$ On glass-epoxy P.C.B (Note 1)	$I_{(AV)}$	0.8							A
Peak forward surge current, 8.3ms single half sine-wave superimposed on rated load	$I_{FSM}$	30.0							A
Rating for fusing ( $t=8.3\text{ms}$ , $T_a=25^\circ\text{C}$ )	$I_t^2$	3.73							$A_s^2$
Maximum instantaneous forward voltage at 0.8A	$V_F$	1.0							V
Maximum DC reverse current $T_A=25^\circ\text{C}$ at rated DC blocking voltage $T_A=125^\circ\text{C}$	$I_R$	2.0 200							$\mu\text{A}$
Typical junction capacitance (Note 2)	$C_J$	15.0							pF
Typical thermal resistance	$R_{qJA}$	72.0							$^\circ\text{C/W}$
Operating junction and storage temperature range	$T_J, T_{STG}$	-55 to +150							$^\circ\text{C}$

**Note:** 1. Mounted on glass epoxy PC board with 1.3\*1.3mm solder pad  
2. Measured at 1MHz and applied reverse voltage of 4.0V D.C.

**Single Phase 0.8Amp Glass passivated Bridge Rectifiers**

**Ratings And Characteristic Curves**

FIG. 1- DERATING CURVE OUTPUT RECTIFIED CURRENT

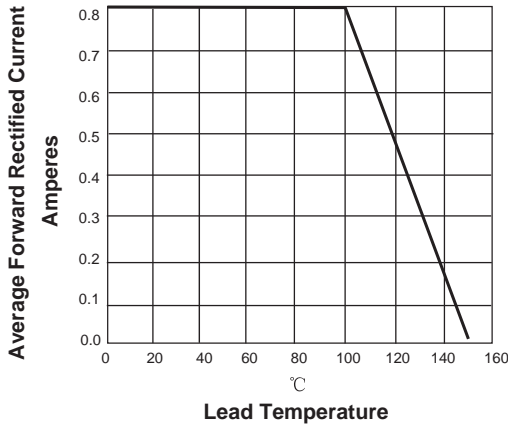

FIG. 2-MAXIMUM NON-REPETITIVE PEAK FORWARD SURGE CURRENT PERLEG

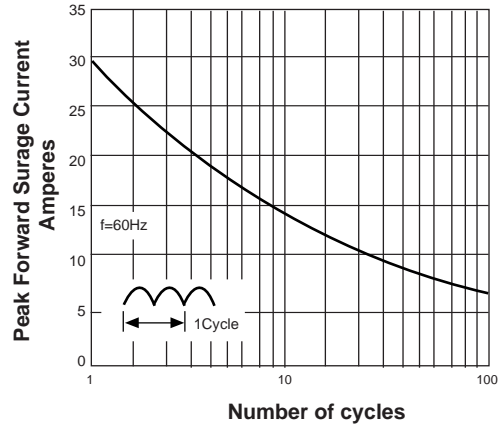

FIG. 3-TYPICAL FORWARD VOLTAGE CHARACTERISTICS

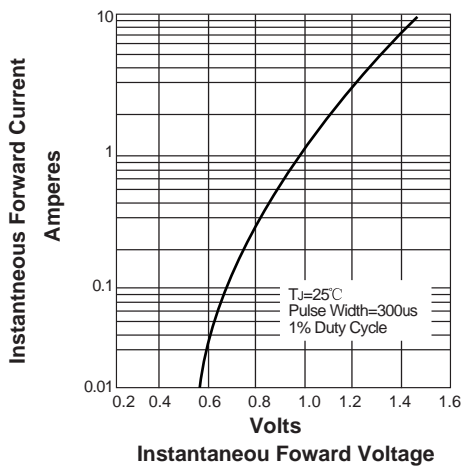
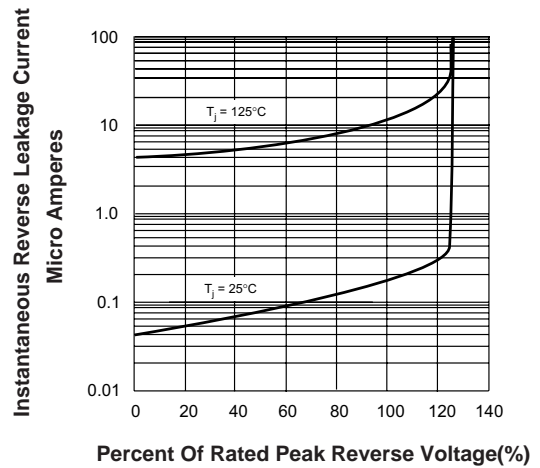
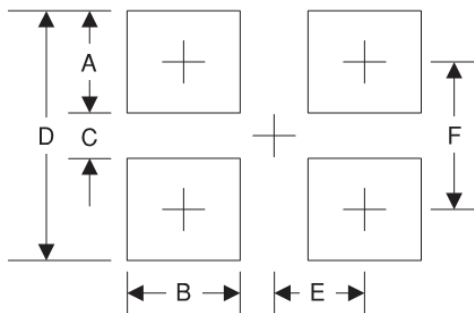

FIG. 4-TYPICAL REVERSE LEAKAGE CHARACTERISTICS



**Suggested Pad Layout**



Symbol	Unit (mm)	Unit (inch)
A	1.7	0.067
B	1.0	0.039
C	4.40	0.173
D	8.10	0.319
E	1.25	0.049
F	6.30	0.248

**Single Phase 0.8Amp Glass passivated Bridge Rectifiers**

**Suggested Soldering Temperature Profile**

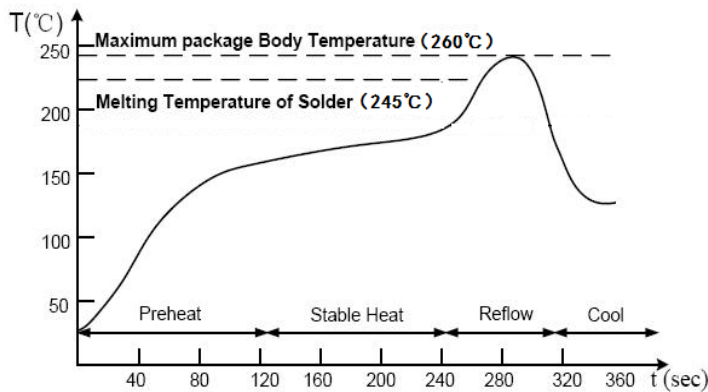

**Note**

- ◆ Recommended reflow methods: IR, vapor phase oven, hot air oven, wave solder.
- ◆ The device can be exposed to a maximum temperature of 260°C for 10 seconds.
- ◆ Devices can be cleaned using standard industry methods and solvents.
- ◆ If reflow temperatures exceed the recommended profile, devices may not meet the performance requirements.

**Package Information**

**Carrier Dimension(mm)**

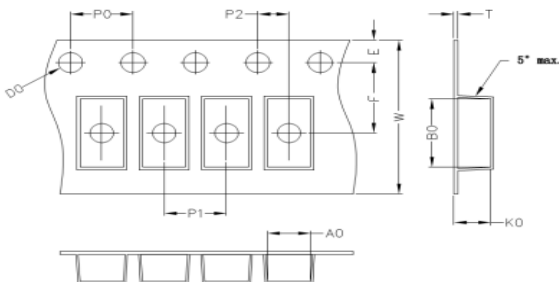

A0	B0	K0	D0	E	F
5.10	7.20	2.88	1.55	1.75	5.50
P0	P1	P2	T	W	Tolerance
4.0	8.0	2.0	0.25	12	0.1

**Package Specifications**

Package	Reel Size	Reel DIA. (mm)	Q'TY/Reel (Kpcs)	Box Size (mm)	QTY/Box (Kpcs)	Carton Size (mm)	Q'TY/Carton (Kpcs)
MBS	13'	330	3	338	6	365*365*360	48